

|      |      |         |
|------|------|---------|
| OI   | DATE | ALTERED |
|      |      | CHECKED |
| ZONE |      |         |

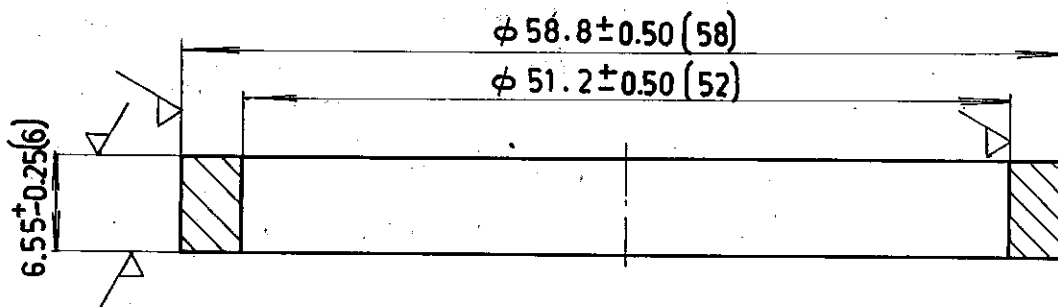

**NOTE:**

1. ✓ MARK INDICATES THE SURFACES TO BE MACHINED FURTHER
2. REFER DRG: 4-20-201-00565 FOR MACHINING
3. HARDNESS: 41-44 HRC
4. MATERIAL: Cr 29 ; W 9 ; C 1.8 ; REMAINING Co (STEELITE 12)
5. PROCESS : INVESTMENT CASTING WITH SHELL INOCULATION
6. DIMENSIONS SHOWN IN BRACKETS ARE FINAL DIMENSIONS
7. REFER DRG. 4-20-001-01420 FOR CASTING REQUIREMENTS

[illegible]